

RoHS  
Compliant

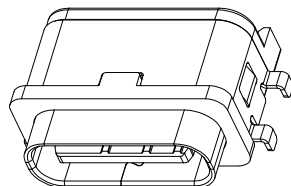
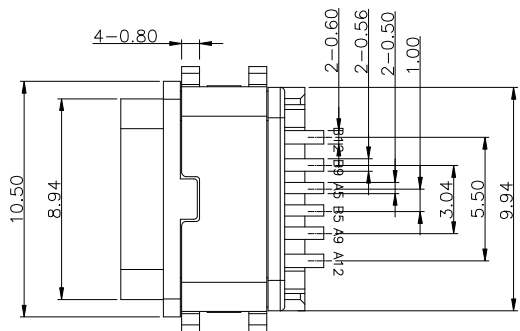

NOTES:

SPECIFICATION:

1. CURRENT RATING: 3.0A MAX
2. VOLTAGE: 100 VAC
3. TEMPERATURE RANGE: -30 °C ~ 85 °C
4. CONTACT RESISTANCE: 40 MILLIONHM MAX
5. INSULATION RESISTANCE: 100 MEGOHMS MIN.
6. INSERTION FORCE : 5N~20N
7. UNMATING FORCE: 8N~20N
8. DURABILITY: 10,000 CYCLES
9. WATER PROOFNESS: THIS PRODUCT IS BASED ON IPX7.

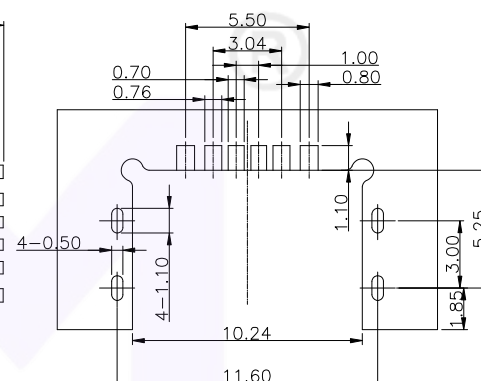
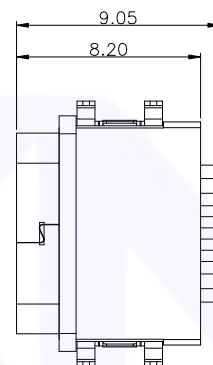
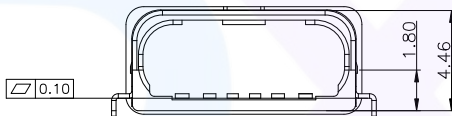
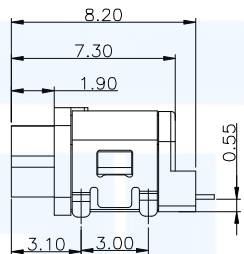
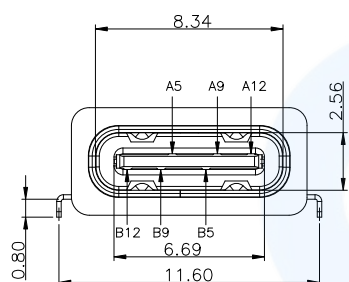
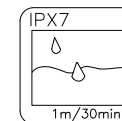

RECOMMENDED P.C.B. LAYOUT  
TOLERANCE UNSPECIFIED ±0.05mm

A5	CC1	B12	GND
A9	VBUS	B9	VBUS
A12	GND	B5	CC2
PIN	SIGNAL NAME	PIN	SIGNAL NAME

5	SHELL	SUS304R-1/2H	NI Plated	1PCS
4	SHIELDING PLATE	SUS304R-1/2H	NI Plated	1PCS
3	CONTACT	C2680R-EH	TIN/Au/Ni Plated	1SET
2	SHELL HOUSING	PA-9t	BLACK	1PCS
1	HOUSING	PA-9t	BLACK	1PCS
NO.	DESCRIPTION	MATERIAL	REMARKS	QTY

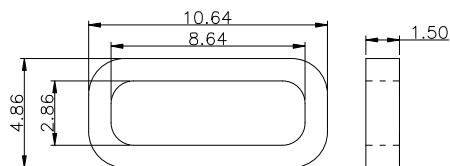

建议的胶圈尺寸

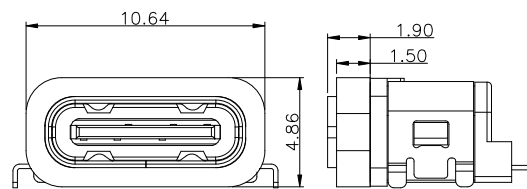

加防水圈示意图

广东小迈实业有限公司

Website:

<https://www.xmconn.com>

TEL:

18938295888



PART NAME

C F 单排沉板6P四脚插板防水型母座

PART NO.

DM68001-06FBAP-A

TOLERANCE UNLESS OTHERWISE SPECIFIED:  
X ±0.2  
X.X ±0.15  
X.XX ±0.10  
X.XXX ±0.050

DRAWING:

Li

DATE:

2023.08.18

SCALE

SHEET

REV: AO

CHECK:

Chen

DATE:

2023.08.18

1:1

1/2

SIZE: A4

APPROVAL:

Wen

DATE:

2023.08.18



RoHS  
Compliant



6P防水型四脚



6P防水型两脚



6P防水板上型

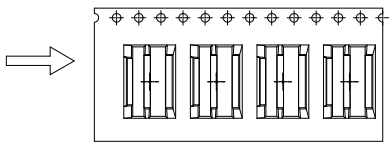

① 产品入载带示意图

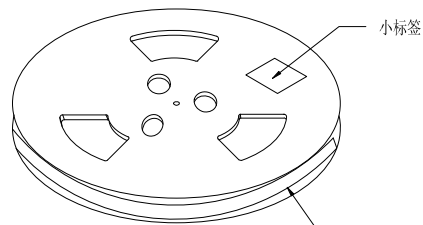

② 卷盘贴标签示意图

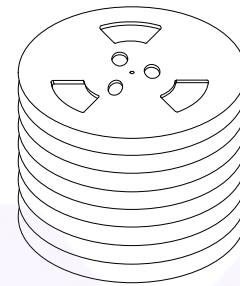

③ 10层产品叠层示意图

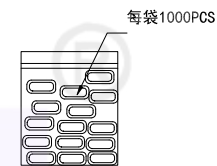

防水圈袋示意图

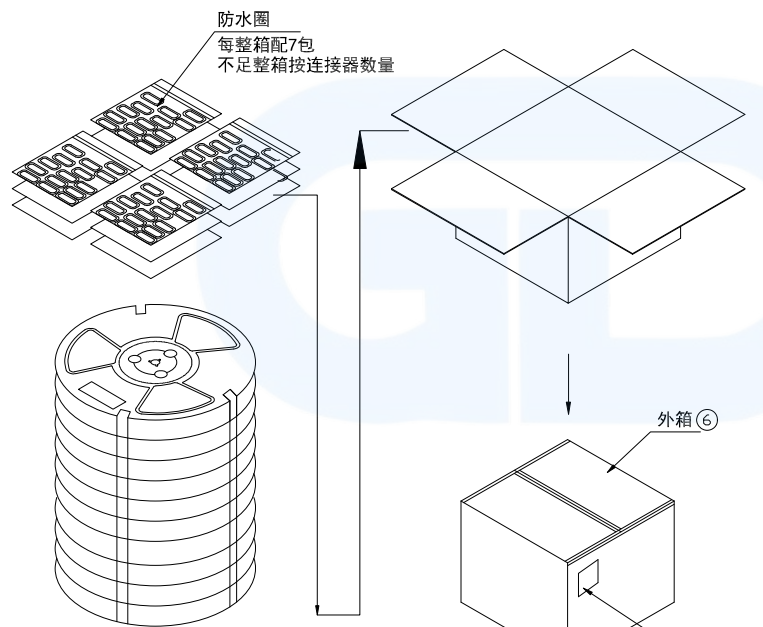

④ 产品入外箱示意图

⑤ 外箱封箱示意图

NOTE:

1. QUANTITY/REEL: 700 PCS  
数量/卷: 700 PCS  
QUANTITY/INNER CARTON: 700 X 10 = 7000 PCS  
数量/箱: 700 X 10 = 7000 PCS
2. FREE 16 CAVE IN THE FRONT CARRIER AND FREE 16 CAVE IN THE END CARRIER.  
包装带内圈空16格, 外圈空16格.

1	成品		C 6P防水型沉板母座成品	8000
2	CARRIER TAPE	PET	W=24mm T=0.35mm	—
3	COVER TAPE	PET	W=13.3mm T=0.05mm	—
4	小标签		L102mm*W59mm	10
5	卷盘	PS	φ330MM*W28.5MM	10
6	外标签		L102mm*W102mm	1
7	外箱	A=A	L330mm*W330mm*H320mm	1
ITEM	DESC.	MATERIAL	REMARKS	QTY

广东小迈实业有限公司

Website:

<https://www.xmconn.com>

TEL:

18938295888



PART NAME

TYPE C F沉板6PIN 沉板插板防水型母座 一包装规范

PART NO.

DM68001-06FBAP-A

TOLERANCE UNLESS OTHERWISE SPECIFIED:  
X ±0.2  
X.X ±0.15  
X.XX ±0.10  
X.XXX ±0.050

DRAWING:

Li

DATE:

2023.08.18

SCALE

SHEET

REV: A0

CHECK:

Chen

DATE:

2023.08.18

1:1

2/2

SIZE: A4

APPROVAL:

Wen

DATE:

2023.08.18

