

RoHS
Compliant

ZONE	ECN.N.O.	DESCRIPTION	DRAWING	DATE
A		INITIAL	林生财	2023.12.29

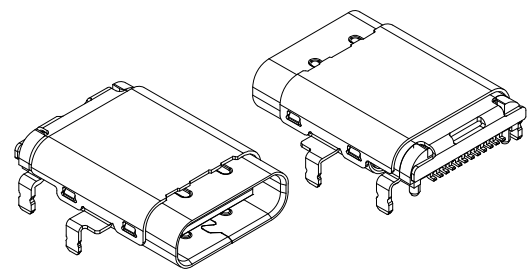

- MATERIAL:
HOUSING: LCP HIGH TEMPERATURE PLASTIC V-0, BLACK
CONTACT: C18150
SHELL: SUS304
SHELL: SUS304
EMI PLATE: SUS304
MID PLATE: SUS301
- PLATING SPECIFICATION:
2-1 CONTACT: COPPER ALLOY.
G/F PLATED ON CONTACT AREA,
G/F PLATED ON SOLDER AREA,
Ni 50u" MIN. UNDER PLATED OVER ALL.
2-2 SHELL: STAINLESS STEEL
50u"MIN NICKEL PLATING OVER ALL.
2-3 SHELL: STAINLESS STEEL
50u"MIN NICKEL PLATING OVER ALL.
2-4 EMI PLATE: MATERIAL
2-5 MID PLATE: MATERIAL

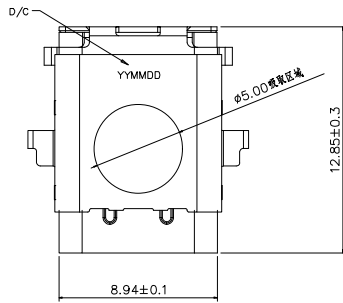
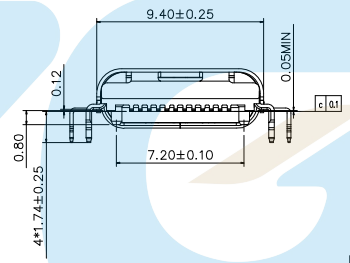
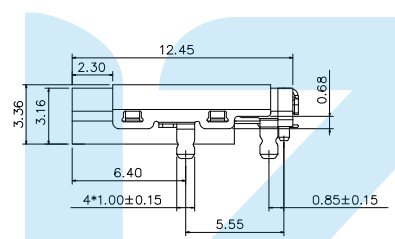
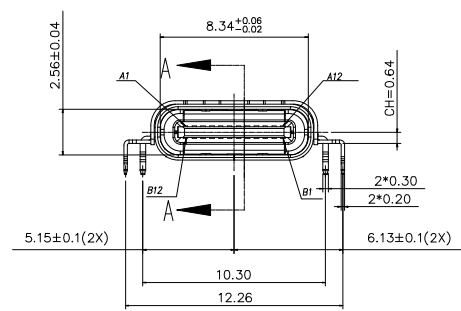

- MECHANICAL:
INSERTION: 5~20N.
EXTRACTION: 8~20N.
DURABILITY: 10000 CYCLES
- ELECTRICAL:
CURRENT: 5A MIN FOR VBUS; 1.25A MIN. FOR VCONN;
0.25A MIN FOR OTHER.
VOLTAGE: 5VAC MAX
WITHSTANDING VOLTAGE: 100V AC.
CONTACT RESISTANCE: 40mΩ MAX.
INSULATION RESISTANCE: 100MΩ MIN.
- ENVIRONMENTAL
TEMPERATURE RANGE -40°C ~ +120°C

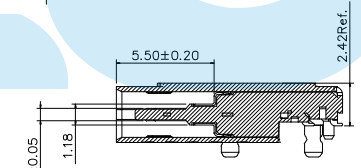
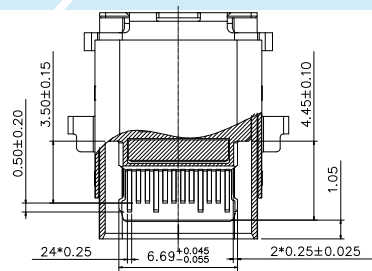
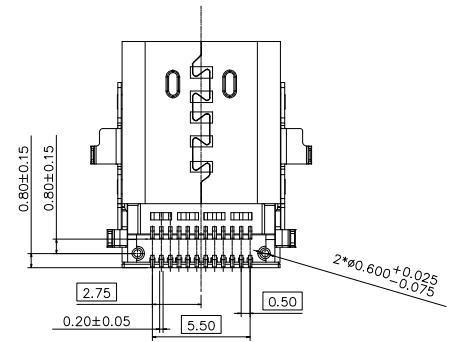

剖面图
比例: 1 A-A

YY MM DD
DAY(
MONTH(
YEAR(
)

LZG LZG INDUSTRIAL CO. LTD

PART NAME	CF 24P 双排 SMT 沉板 L=12.85	TOLERANCE UNLESS	0.0±0.25	0.1±2*	UNIT: mm	APPROVAL:	林生财	DATE:	2023.12.29	SCALE	1:1
PART NO.	ZB48080-24SBAP-A	OTHERWISE SPECIFIED:	0.00±0.15	0.0±1*			CHECK:	李宏鑫	DATE:	2023.12.29	MATERIAL
			0.000±0.05	0.00±0.5*		DRAWING NO.	杨进宝	DATE:	2023.12.29	DWG. NO.	
									ZB48080-24SBAP-A	SHEET	1/1

DRAWING:	林生财	DATE:	2023.12.29	SCALE	1:1
CHECK:	李宏鑫	DATE:	2023.12.29	MATERIAL	*
APPROVAL:	杨进宝	DATE:	2023.12.29	DWG. NO.	
DRAWING NO.	ZB48080-24SBAP-A			SHEET	1/1