

RoHS
Compliant

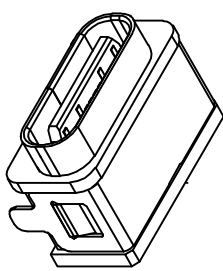

3D VIEW

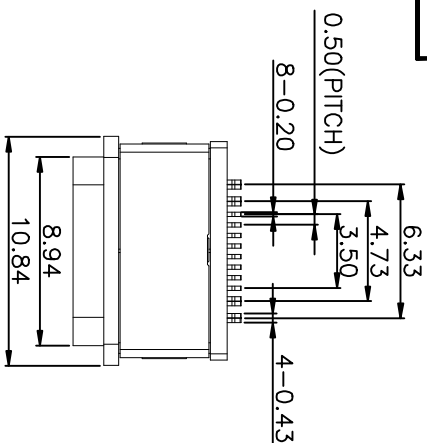

SPECIFICATIONS:

- CURRENT RATING: 3.0A MAX.
- DIELECTRIC WITHSTAND VOLTAGE: 100VAC
- TEMPERATURE RANGE: -30 °C ~ 85 °C
- CONTACT RESISTANCE: 40 MILLIONHM MAX
- INSULATION RESISTANCE: 100 MEGOHMS MIN.
- INSERTION FORCE : 5N~20N
- UNMATING FORCE: 8N~20N
- DURABILITY:10,000 CYCLES
- WATER PROOFNESS:THIS PRODUCT IS BASED ON IPX8.

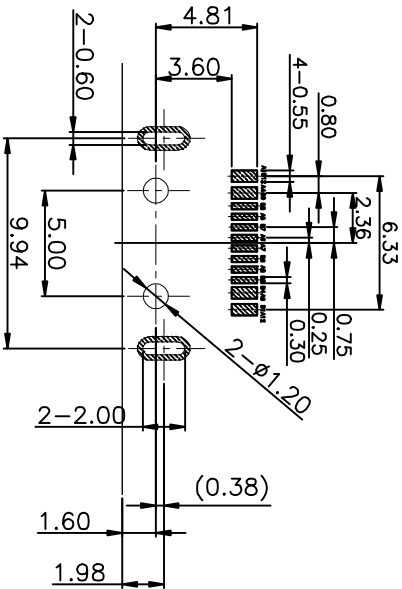
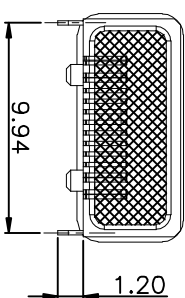
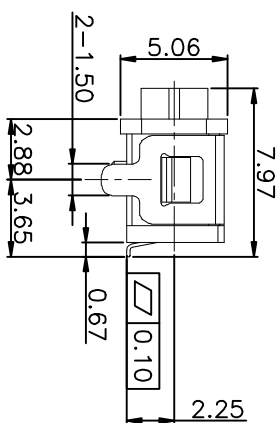
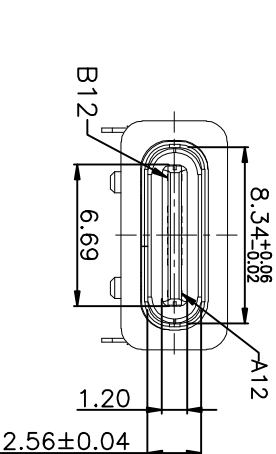

Recommended P.C.B. Layout
Unspecified Tolerance:±0.05

PIN	SIGNAL NAME	PIN	SIGNAL NAME	NO.	DESCRIPTION	MATERIAL	REMARKS	QTY
A1	GND	B12	GND	5	SHELL 2	SUS304	Ni PLATING T=0.2mm	1
A4	VBUS	B9	VBUS	4	SHELL 1	SUS304	Ni PLATING T=0.3mm	1
A5	CC1	B8	SBU2	3	HOUSING 2	PA10T	COLOR BLACK	1
A6	DP1	B7	DN2	2	CONTACT	C7025 TM03	Au/Ni PLATING T=0.15mm	16
A7	DN1	B6	DP2	1	HOUSING 1	PA10T	COLOR BLACK	1
A8	SBU1	B5	CC2					
A9	VBUS	B4	VBUS					
A12	GND	B1	GND					

结构设计注意:
成品使用时, 如有流面物泡沫、牙膏、洗手液、脏污液体, 请在TYPE-C口外面再设计一层外壳, 保护TYPE-C表面全手指不会被脏污覆盖。

LZG INDUSTRIAL CO., LTD

PART NAME WATERPROOF TYPE C 16PIN
PART NO. ZB48006-16SBAP-A

TOLERANCE UNLESS OTHERWISE SPECIFIED: 0.00±0.1
0.00±0.05

0.±0.3
0.00±0.1
0.00±0.5

0.±0.2
0.0±0.1
0.00±0.5

UNIT: mm
DRAWING NO. ZB48006-16SBAP-A

DRAWING: 林生财
CHECK: 李安鑫
DATE: 2020.02.18
SCALE: 1:1
DATE: 2020.02.18
MATERIAL: *
DATE: 2020.02.18
DWG. NO.
SHEET: 1/2

RoHS
Compliant

ZONE		E.C.N. NO.		DESCRIPTION		DRAWING		DATE	
A				INITIAL		林生财		2020.02.18	

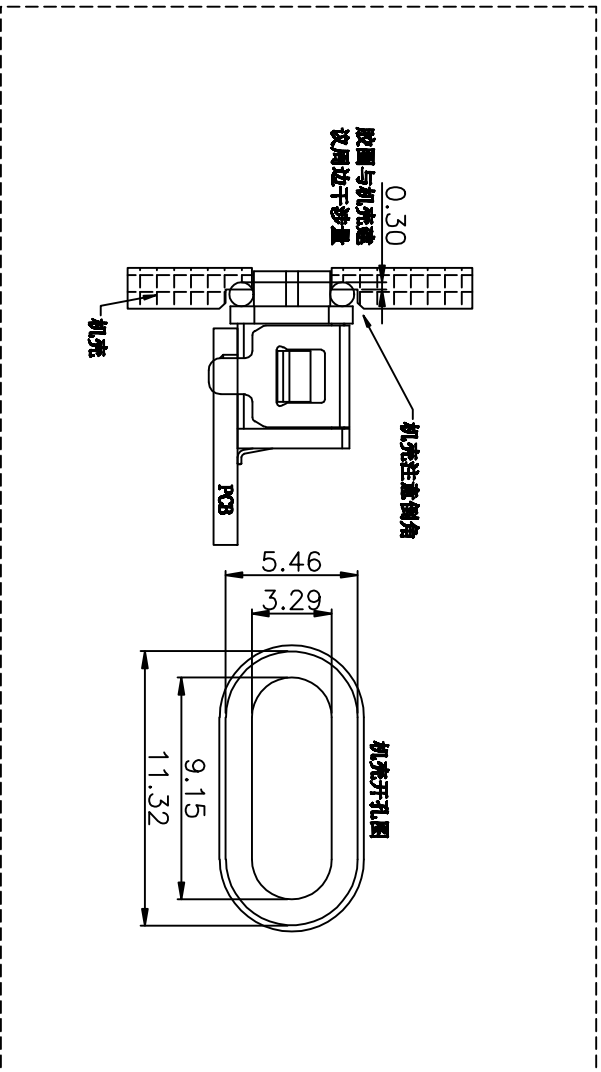
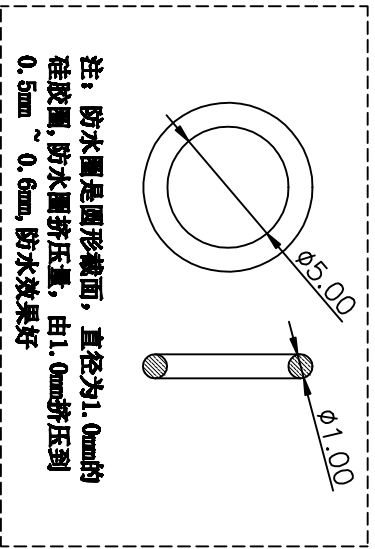

LZG

LZG INDUSTRIAL CO. LTD

PART NAME	WATERPROFF TYPE C 16PIN	TOLERANCE UNLESS	0.0±0.3	0.1±2°	UNIT:	mm	DRAWING:	林生财	DATE:	2020.02.18	SCALE	1:1
PART NO.	ZB48006-16SBAP-A	OTHERWISE SPECIFIED:	0.00±0.1	0.0°±1'			CHECK:	李秋鑫	DATE:	2020.02.18	MATERIAL	*
			0.000±0.05	0.00°±0.5'			APPROVAL:	杨进宝	DATE:	2020.02.18	DWG. NO.	
							DRAWING NO.	ZB48006-16SBAP-A			SHEET	2/2

F

E

D

C

B

A

4

3

2

1

4

3

2

1